

SLAM-SHUT VALVES

Type BM6X



BM6X Slam-Shut Valves

Slam-shut valves

The BM6X series axial flow slam-shut valve is an automatic shut-off appliance suitable for installation as a safety device in regulating stations and on gas transfer and distribution lines.

The reduced face to face dimension, which is typical of wafer valves, facilitates installation even in existing regulating station that are not equipped with shut-off devices.

The slam-shut valve rapidly interrupts the gas flow in cases in which the pressure at the control point or points reaches the set level.

The BM6X slam-shut valves are of the "wafer" type with an off-center butterfly disk that is mounted eccentrically.

The gas flow favors closure of the valve.

The valve can only be re-opened manually.

The BM6X series slam-shut valve uses gas from the gas line for operation and therefore it does not require outside sources to operate.

The main features are as follows:

- *Axial flow*
- *"Wafer" type valve*
- *Off-center butterfly disk*
- *Pressure control at one or more points in the system*
- *Activation due to pressure increase or decrease*
- *Emergency slam-shut push-button*
- *Button by-pass with automatic return*
- *Manual reset by the sole rotation of the reset shaft*
- *Easy maintenance*



Operation

The BM6X series slam-shut valve consists of a "wafer" type valve body, an pilot and a by-pass valve.

The valve body has an off-center butterfly disk that is mounted eccentrically on the reset shaft.

A lip seal ensures tightness.

The spring thrust, with the additional weight of the eccentric off-center butterfly disk, ensures punctual and safe closure under any working conditions.

In addition, the compression of the seal, which is determined by the pressure, ensures perfect tightness.

The slam-shut valve can only be opened if the upstream and downstream pressures are equal.

The IT/2V by-pass valve with automatic return makes it possible to balance these pressures.

The valve can only be opened manually by rotating the pilot reset shaft.

When the controlled pressure lies within the set levels for the pilot, the latter remains set and prevents rotation of the shaft while keeping the butterfly disk open.

When said pressure changes beyond the set levels, the butterfly disk moves to the closure position.

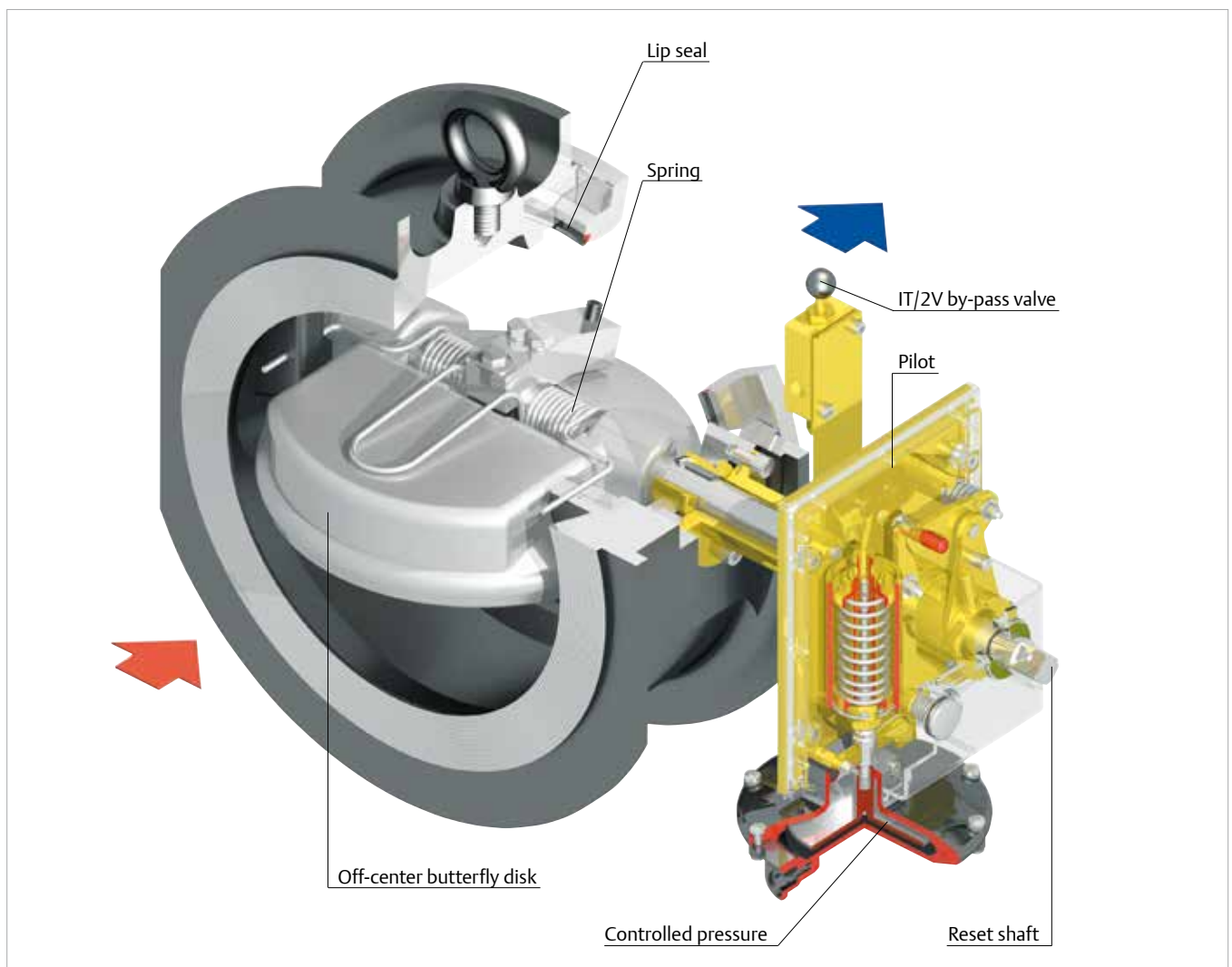

BM6X Slam-Shut Valves

Features

Applications The slam-shut valves in the BM6X series are used in natural gas reduction, distribution and transfer stations. They can also be used with air, propane, butane, LPG, city gas, nitrogen, carbon dioxide and hydrogen.

Construction Features

The flange coupling surfaces are normally supplied with a step and finished with a semicircular profile phonographic groove.

Upon request, the flange coupling surfaces can be supplied with a smooth finish.

Upon request, the valve can be supplied complete with flanges to be welded to the line, stud bolts, nuts and gaskets.

Technical Features

Pressure (bar)		ANSI 150	ANSI 300	ANSI 600
Allowable pressure	PS	20	50	100
Inlet pressure range	b _{pu}	0 ÷ 20	0 ÷ 50	0 ÷ 100
Overpressure set range	W _{do}	0.03 ÷ 20	0.03 ÷ 50	0.03 ÷ 80
Underpressure set range	W _{du}	0.01 ÷ 20	0.01 ÷ 50	0.01 ÷ 80
Accuracy class	AG	up to ± 1%		
Response time	t _a	≤ 1 s		

Flanged connections

DN 80 - 100 - 150 - 200 - 250 - 300

Temperature

Standard version

Working -10 °C +60 °C

Low temperature version

Working -20 °C +60 °C

Materials

Body	Steel
Butterfly disk	Cast iron or steel
Shaft	Steel
Spring	Stainless steel
Lip seal	FKM
O-ring	NBR nitrile rubber or FKM

By-Pass Valve Type IT/2V Features

Allowable pressure	PS: 100 bar
Material	Brass
1/4" NPT female threaded pipe fitting	

Versions

Sour Gases The version referring to NACE standard is produced for use with sour gases (not available with the OS/80X-R-PN series pilot).

Application graph based on the amount of H_2S present in the gas

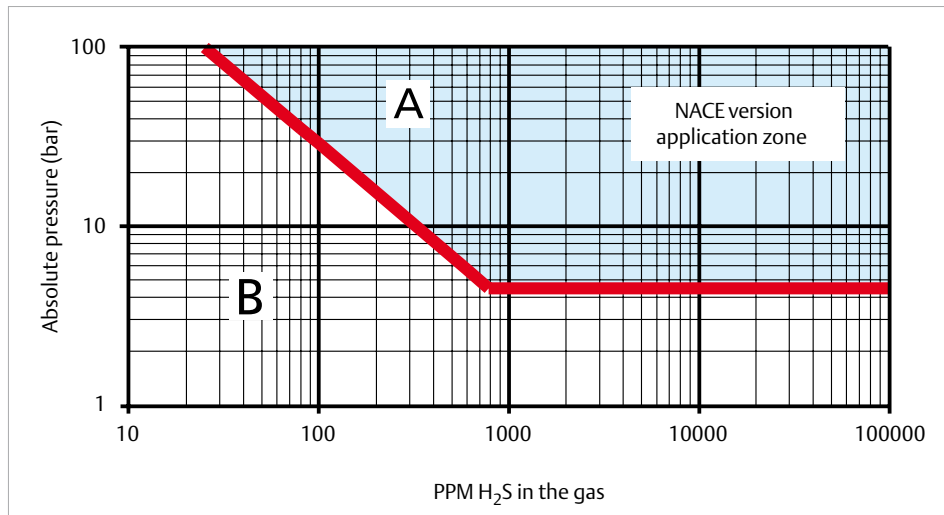

The red line divides the graph into two zones.

The "A" zone indicates the range in which the NACE version must be used.

The "B" zone indicates the range in which that version is not required.



BM6X Slam-Shut Valves

Calculation procedures

The following formulas refer to normal operating conditions in a sub-critical state with: $P_2 > \frac{P_1}{2}$

Symbols

Q = Natural gas flow rate in Stm³/h
 P1 = Absolute inlet pressure in bar
 P2 = Absolute outlet pressure in bar

C_g = Flow rate coefficient
 C1 = Body shape factor
 d = Relative density of the gas

Flow Coefficients

Coefficient	DN 80	DN 100	DN 150	DN 200	DN 250	DN 300
C _g	4500	9000	20250	36000	55800	81000
C1	18					

Flow Rate Q

$$Q = 0.525 \cdot C_g \cdot P_1 \cdot \sin \left(\frac{3417}{C_1} \cdot \sqrt{\frac{P_1 - P_2}{P_1}} \right)^{\text{Deg}}$$

$$Q = 0.525 \cdot C_g \cdot P_1$$

For other gases with different densities, the flow rate calculated with the above formulas must be multiplied by the correction factor:

$$F = \sqrt{\frac{0.6}{d}}$$

Gas	Relative Density d	Factor F
Air	1	0.78
City gas	0.44	1.17
Butane	2.01	0.55
Propane	1.53	0.63
Nitrogen	0.97	0.79
Carbon dioxide	1.52	0.63
Hydrogen	0.07	2.93

Power Loss Δp

$$\Delta p = \frac{P_1 - \sqrt{P_1^2 - 4 \cdot \left(\frac{Q}{C_g \cdot 1.05} \right)^2}}{2}$$

DN Size

Calculate the required C_g with the following:

$$C_g = \frac{Q}{0.525 \cdot P_1 \cdot \sin \left(\frac{3417}{C_1} \cdot \sqrt{\frac{P_1 - P_2}{P_1}} \right)^{\text{Deg}}}$$

N.B. The formula appearing above is valid only when the flow rate refers to natural gas. For other gases, divide the flow rate by the correction factor F.

Choose the slam-shut valve with the C_g higher than the calculated value. After having determined the slam-shut valve diameter, it is suggested to check that the velocity on the seal seat is not higher than 80 m/sec. by using the following formula:

$$V = 345.92 \cdot \frac{Q}{DN^2} \cdot \frac{1 - 0.002 \cdot P_u}{1 + P_u}$$

V = Velocity (m/s)
 345.92 = Numerical constant
 Q = Flow rate under standard conditions (Stm³/h)
 DN = Valve nominal diameter (mm)
 P_u = Inlet pressure in relative value (bar)

In case of velocities higher than indicated limits, increase the valve diameter.

Pilot

The following pilots are used with the BM6X slam-shut valves:

- **OS/80X-R Series:** Spring loaded pneumatic device
- **OS/80X-R-PN Series:** Pneumatic device controlled by PRX series pilots

OS/80X-R

The OS/80X-R series pilot is supplied in different models according to set ranges required.

Technical Features

Model		Body Resistance (bar)	Overpressure Set Range W_{do} (bar)		Underpressure Set Range W_{du} (bar)	
Valve Flow from Left to Right	Valve Flow from Right to Left		Min.	Max.	Min.	Max.
OS/80X-BP-S-R	OS/80X-BP-R	5	0.03	2	0.01	0.60
OS/80X-BPA-D-S-R	OS/80X-BPA-D-R	20				
OS/80X-MPA-D-S-R	OS/80X-MPA-D-R	100	0.50	5	0.25	4
OS/80X-APA-D-S-R	OS/80X-APA-D-R		2	10	0.30	7
OS/84X-S-R	OS/84X-R		5	41	4	16
OS/88X-S-R	OS/88X-R		18	80	8	70

Materials

OS/80X-R

Servomotor body OS/80X-BP-R, OS/80X-BPA-D-R Aluminum
OS/80X-MPA-D-R, OS/80X-APA-D-R Steel
Diaphragm Fabric-finished NBR
O-ring NBR rubber

OS/84X-R, OS/88X-R

Servomotor body Brass
Lip seal Teflon (PTFE)
O-ring NBR rubber



OS/80X-BP-R

OS/80X-R-PN

The OS/80X-R-PN series pilot is supplied in two models:

OS/80X-R-PN: Pressure range 0.5 to 40 bar.

Appliance made of an OS/80X-APA-D-R set at about 0.4 bar and a variable number of PRX/182 pilots for overpressure and PRX/181 for underpressure, as many as necessary to control different points of the installation.

OS/84X-R-PN: Pressure range 30 to 80 bar.

Appliance made of an OS/84X-R set at about 20 bar and a variable number of PRX-AP/182 pilots for overpressure and PRX-AP/181 for underpressure, as many as necessary to control different points of the installation.

Technical Features

Model	Body Resistance (bar)	Overpressure Set Range W_{do} (bar)		Underpressure Set Range W_{du} (bar)	
		Min.	Max.	Min.	Max.
OS/80X-R-PN	100	0.5	40	0.5	40
OS/84X-R-PN	100	30	80	30	80

Materials

PRX/181/182, PRX-AP/181/182

Body Steel
Diaphragm Fabric-finished NBR
O-ring NBR rubber

BM6X Slam-Shut Valves

Installation and assembly

Orientations The BM6X/ slam-shut valves are normally installed in lines with a horizontal axis. Vertical axis installation is possible but only with a flow direction from top to bottom.

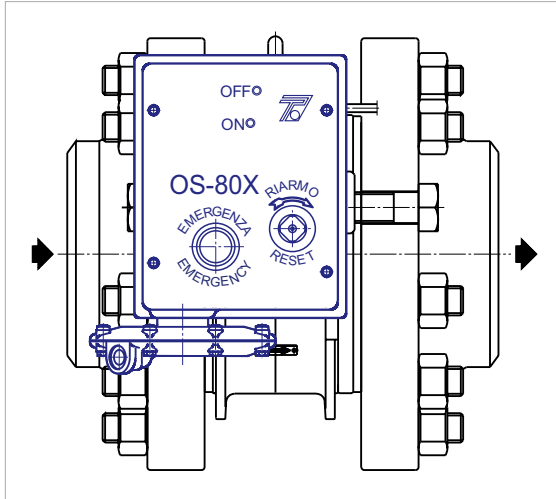

Flow from left to right
OS/80X-S-R Clockwise resetting

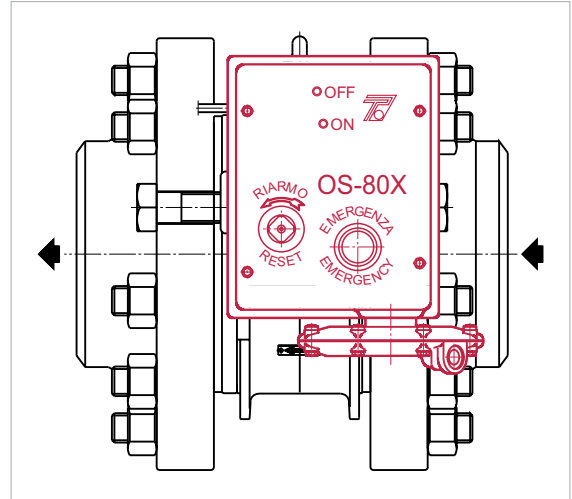

Flow from right to left
OS/80X-R Counterclockwise resetting

Off-Center Butterfly Disk Adjusting

In the event of replacement of the OS/80X-R or valve disassembly for maintenance work, it is very important to check the level of the "C" height indicated in the following table prior to reinstalling the valve on the line. If necessary, use the respective dowel to adjust the position of the off-center butterfly disk to avoid the occurrence of irregular loads due to the impact of the fluid.

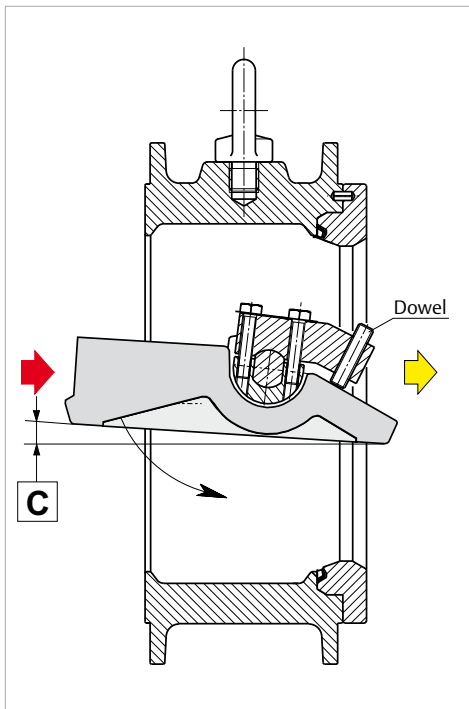

Type	C
BM6X/80	Min. 1 mm - Max. 3 mm
BM6X/100	Min. 1 mm - Max. 5 mm
BM6X/150	Min. 3 mm - Max. 8 mm
BM6X/200	Min. 5 mm - Max. 10 mm
BM6X/250	Min. 6 mm - Max. 11 mm
BM6X/300	Min. 8 mm - Max. 13 mm

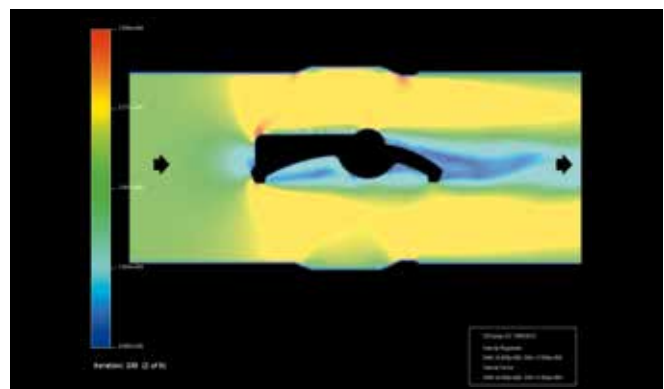

Simulation of the Fluid Mechanics of the Internal Flows

In the event of grit or grime in the lines, it is advisable to install a filter upstream with a filtering capacity of at least 20 microns.

Accessories

Proximity Switch

In order to send the shut-off opening/closing signal, a proximity switch suitable for installation in hazardous area is used.

The use of this switch foresees the application of an intrinsic safety separation barrier which should be installed in safe area.

The distance between the proximity switch and the barrier should be calculated according to the type of gas and installation electrical specifications.

The proximity switch should be positioned at about 0.5 mm from the stem (S).

The adjustment is made by means of adjusting nuts.

On request it is possible to supply the pilot in the version with two proximity switches in order to indicate extreme positions of valve opening/closing.

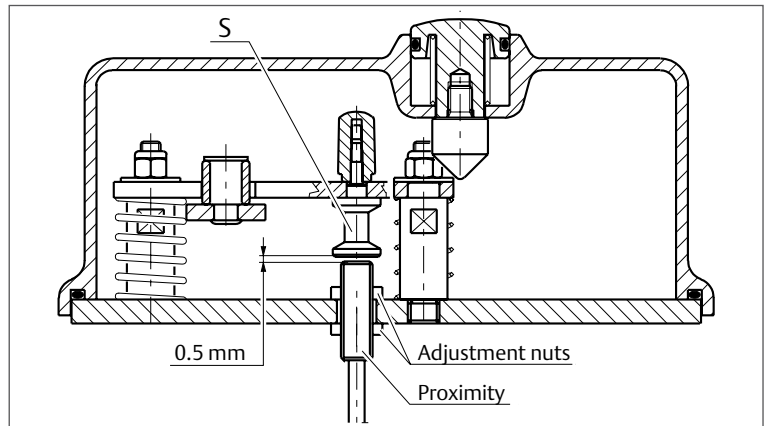

Electrovalve for Remote Controlled Closure

The OS/80X-R and the OS/80X-R-PN equipped with a shut-off device for minimum pressure, can be equipped with a 3-way valve with explosion-proof construction to permit remote-controlled closure.

IT/3V Three-Way Valve for Setting Control (P_u max 50 bar)

It allows the OS/80X-R operation and setting control, without having to change the regulator setting.

The valve is installed on the OS/80X-R control line and it must be connected to a suitable pressure source that is capable of reaching the settings of the OS/80X-R.

The IT/3V three-way valve is of the spring-return type and it is equipped with a safety lock plate (B) on the control knob (Q).

When the plate (B) is pivoted, pressure on the knob (Q) makes it possible to put the sensitive member into communication with a pressure source, thus making it possible to perform operation and setting tests.

Upon completion of the procedures, releasing the knob will reset normal running conditions. The safety lock plate on the knob prevents accidental maneuvers.

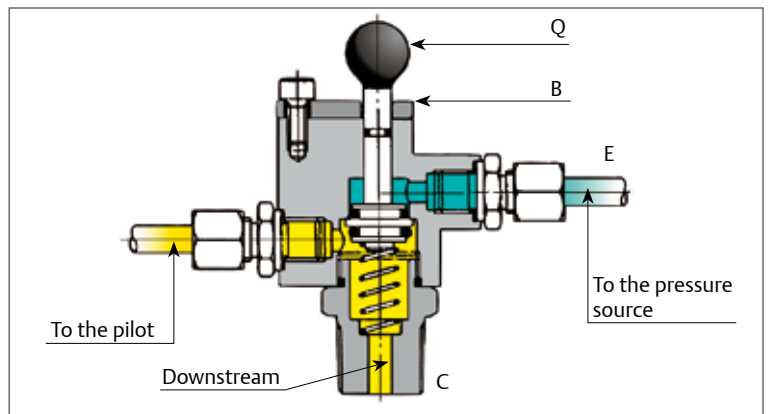
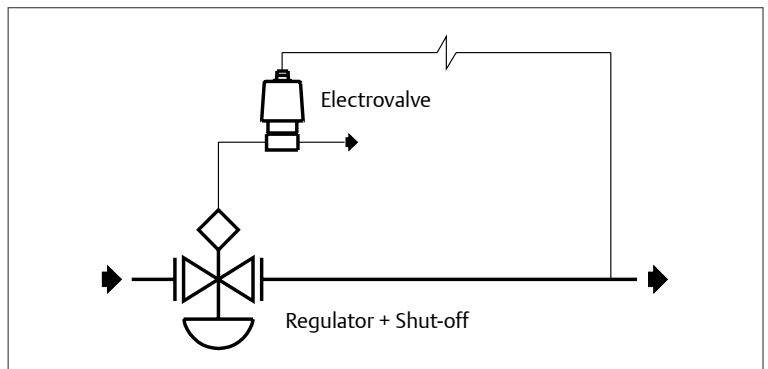

BM6X Slam-Shut Valves

Examples of Connections

Installation in a low pressure regulating line.

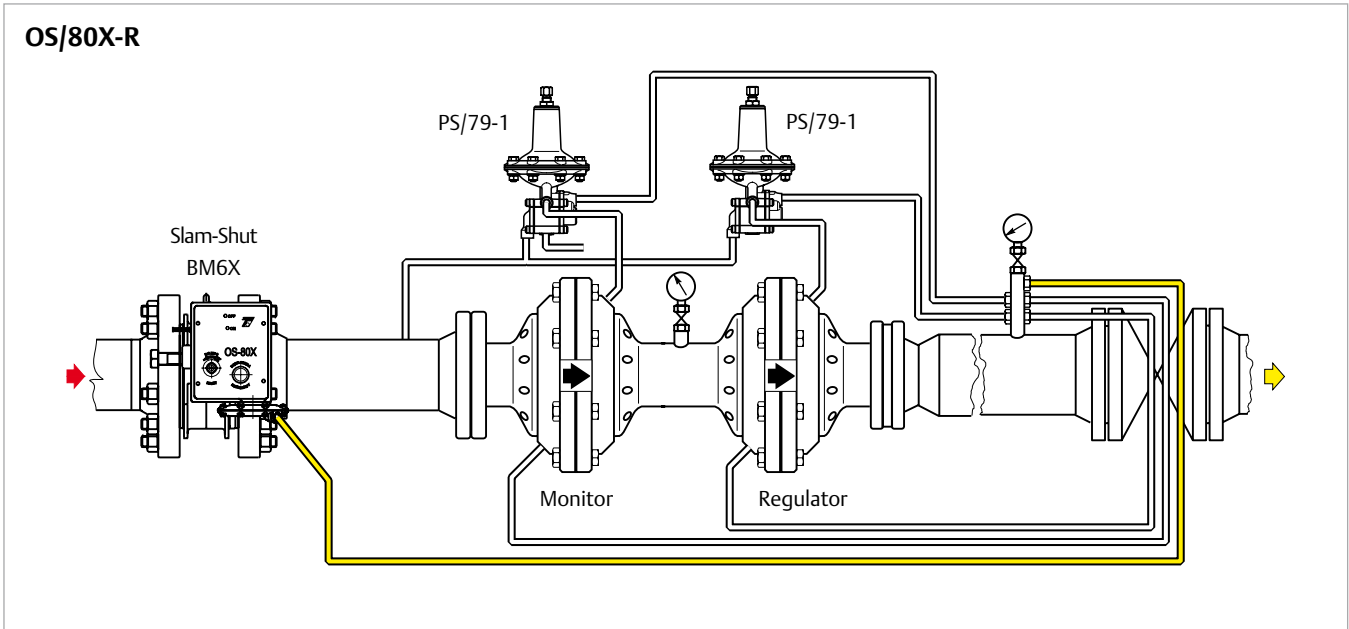

Overpressure and underpressure control downstream of regulators

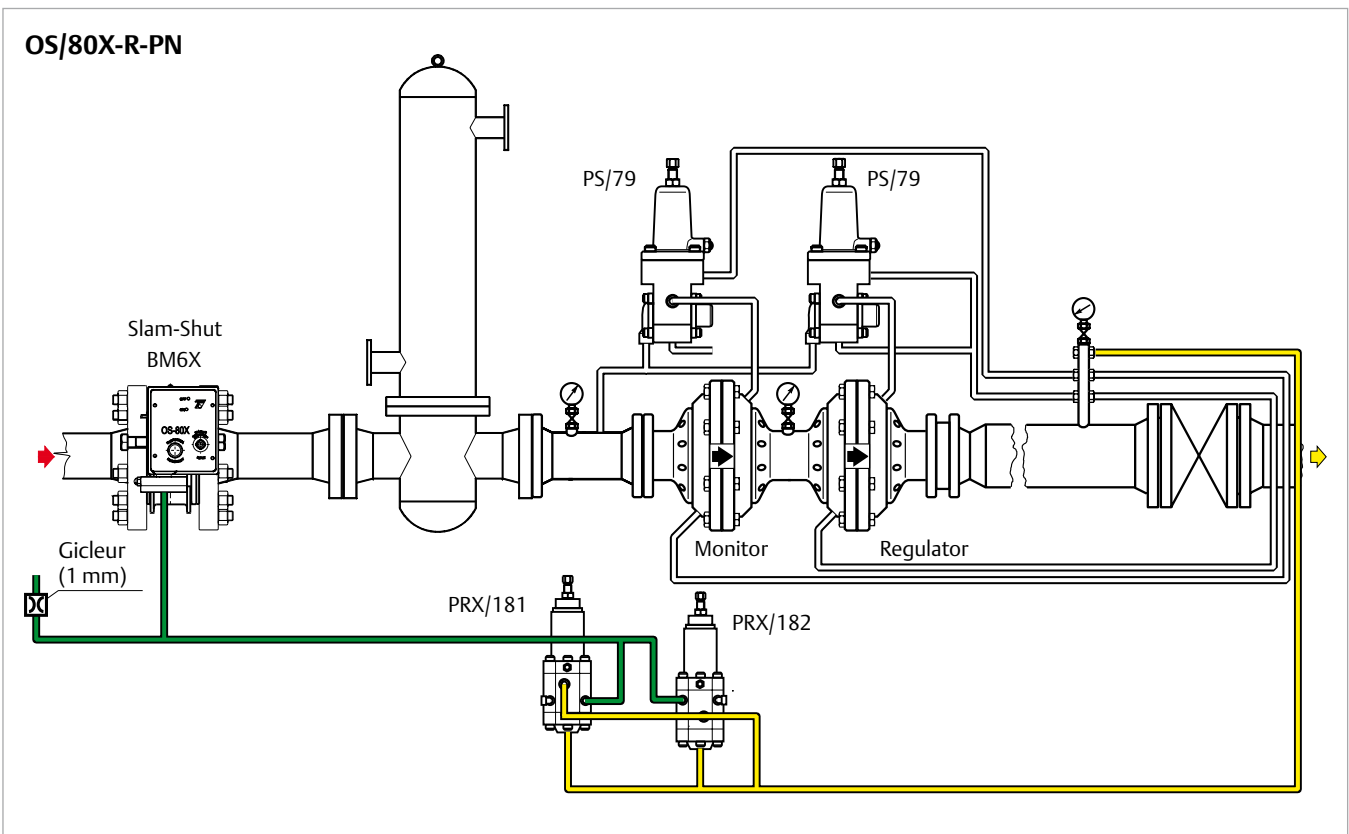

Downstream pressure Atmospheric pressure

Overall Dimensions (mm)

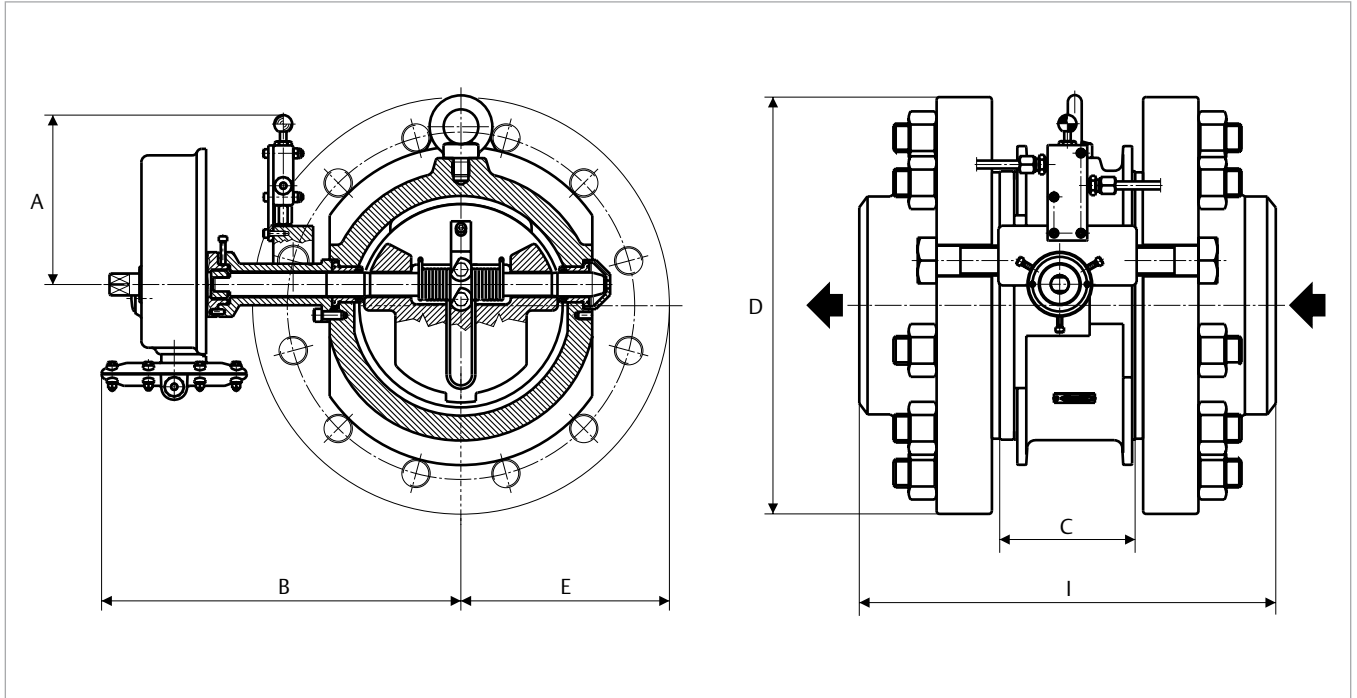

Type		DN 80	DN 100	DN 150	DN 200	DN 250	DN 300
A		155	170	220	220	220	220
B		250	290	415	445	480	510
C		54	70	102	135	168	203
ANSI 150	D	190	230	279	343	406	482
	E	95	115	140	172	203	241
	I	197	227	284	342	375	436
ANSI 300	D	210	254	318	381	445	521
	E	105	127	159	191	223	261
	I	217	245	303	361	407	468
ANSI 600	D	210	274	357	419	508	559
	E	105	137	179	220	254	280
	I	235	264	354	419	490	531

N.B. The B dimensions are indicative and refer to the models with larger dimensions.
The threaded opening for the connection of the control line is 1/4" NPT female.

Weights (kg)

Type	DN 80	DN 100	DN 150	DN 200	DN 250	DN 300
ANSI 150	10	13	22	33	47	81
ANSI 300			26	42	56	90
ANSI 600		15	33	51	85	125

Industrial Regulators

Emerson Process Management Regulator Technologies, Inc.

USA - Headquarters

McKinney, Texas 75070 USA
Tel: +1 800 558 5853
Outside US: +1 972 548 3574

Europe

Bologna 40013, Italy
Tel: +39 051 419 0611

Asia-Pacific

Shanghai 201206, China
Tel: +86 21 2892 9000

Middle East and Africa

Dubai, United Arab Emirates
Tel: +011 971 4811 8100

Natural Gas Technologies

Emerson Process Management Regulator Technologies, Inc.

USA - Headquarters

McKinney, Texas 75070 USA
Tel: +1 800 558 5853
Outside US: +1 972 548 3574

Europe

Bologna 40013, Italy
Tel: +39 051 419 0611
Chartres 28008, France
Tel: +33 2 37 33 47 00

Asia-Pacific

Singapore 128461, Singapore
Tel: +65 6770 8337

Middle East and Africa

Dubai, United Arab Emirates
Tel: +011 971 4811 8100

LP-Gas Equipment

Emerson Process Management Regulator Technologies, Inc.

USA - Headquarters

McKinney, Texas 75070 USA
Tel: +1 800 558 5853
Outside US: +1 972 548 3574

TESCOM

Emerson Process Management Tescom Corporation

USA - Headquarters

Elk River, Minnesota 55330-2445 USA
Tel: +1 763 241 3238
+1 800 447 1250

Europe

Selmsdorf 23923, Germany
Tel: +49 38823 31 287

Asia-Pacific

Shanghai 201206, China
Tel: +86 21 2892 9499

For further information visit www.emersonprocess.com/regulators

Our Global Product Brands:



The Emerson logo is a trademark and service mark of Emerson Electric Co. All other marks are the property of their prospective owners. Fisher, Tartarini, Francel, Emerson Process Management and the Emerson Process Management design are marks of the Emerson Process Management group of companies.

The contents of this publication are presented for informational purposes only, and while every effort has been made to ensure their accuracy, they are not to be construed as warranties or guarantees, express or implied, regarding the products or services described herein or their use or applicability. We reserve the right to modify or improve the designs or specifications of such products at any time without notice.

Emerson Process Management does not assume responsibility for the selection, use or maintenance of any product. Responsibility for proper selection, use and maintenance of any Emerson Process Management product remains solely with the purchaser.

O.M.T. **Officina Meccanica Tartarini S.R.L.**, Via P. Fabbri 1, I-40013 Castel Maggiore (Bologna), Italy
R.E.A 184221 BO Cod. Fisc. 00623720372 Part. IVA 00519501209 N° IVA CEE IT 00519501209, Cap. Soc. 1.548 000 Euro i.v. R.I. 00623720372 - M BO 020330

Francel SAS, 3 Avenue Victor Hugo, CS 80125, Chartres 28008, France
SIRET 552 068 637 00057 APE 2651B, N° TVA : FR84552068637, RCS Chartres B 552 068 637, SAS capital 534 400 Euro