

# Types 64 and 64SR Replacement Parts List

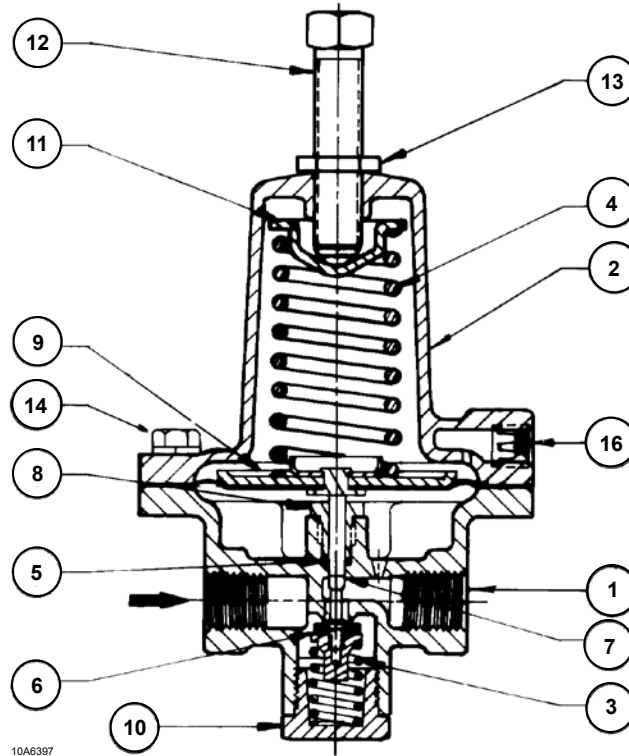

Figure 1. Type 64 LP-Gas Regulator Assembly

## Parts List

Key	Description	Part Number	Key	Description	Part Number
	Replacement Parts Kit (includes keys: 3 - valve spring, 5 - O-ring, 6 - disc holder assembly, 7 - valve stem, 8 - stem guide, 9 - diaphragm assembly, and 16 - vent screen)	R64X0000012	5 <sup>(1)</sup>	O-ring	1D6825T0012
1	Body	T1063708012	6 <sup>(1)</sup>	Disc Holder Assembly	1D6656000A2
2	Spring Case	2P901508012	7	Valve Stem	1D963835172
3	Valve Spring	1D666827222	8	Stem Guide	1D666914092
4	Regulator Spring		9 <sup>(1)</sup>	Diaphragm Assembly (includes: diaphragm, diaphragm head, pusher post, and lower spring guide)	1D6662000A2
	3 to 15 psig (0,21 to 1,03 bar), red	1D892327022	10	Body Plug	1D665209012
	3 to 20 psig (0,21 to 1,4 bar), silver	1D751527022	11	Upper Spring Seat	1D667125072
	5 to 35 psig (0,34 to 2,4 bar), blue	1D665927022	12	Adjusting Screw	1D995448702
	30 to 60 psig (2,1 to 4,1 bar), green	1D745527142	13	Lock Nut	1D667728982
	35 to 100 psig (2,4 to 6,9 bar), yellow	1E543627142	14	Screw (8 required)	1A391724052
			16	Vent Screen	0L078343062
			25	Pipe Plug	1C333528992

1. Recommended spare part.



## Parts List

Key	Description	Part Number
	Replacement Parts Kit (includes keys: 5 - O-ring, 6 - disc holder assembly, 29 - O-ring, and 34 - diaphragm)	R64SRT00012
1	Body	T1063708012
2	Spring Case	2P901508012
3	Valve Spring	1D666827222
4	Regulator Spring	
	3 to 15 psig (0,21 to 1,03 bar), red	1D892327022
	3 to 20 psig (0,21 to 1,4 bar), silver	1D751527022
	5 to 35 psig (0,34 to 2,4 bar), blue	1D665927022
5 <sup>(1)</sup>	O-ring	1D6825T0012
6 <sup>(1)</sup>	Disc Holder Assembly	1D6656000A2
7	Valve Stem	T1047135172
8	Stem Guide	T1046714092
10	Body Plug	1D665209012
11	Upper Spring Seat	1D667125072
12	Adjusting Screw	1D995448702
13	Lock Nut	1D667728982
14	Screw (8 required)	1A391724052
16	Vent Screen (not shown)	0L078343062
28	Spring Seat	T10474X0012
29 <sup>(1)</sup>	O-ring	1H2926X0052
30	Relief Valve Seat	T10473X0012
31	Screw	1A782228982
32	Spring	T10468X0012
33	Lower Spring Guide	T10472X0012
34 <sup>(1)</sup>	Diaphragm	T1047002052
35	Diaphragm Head	T10469X0012
36	Spacer	T10475X0012

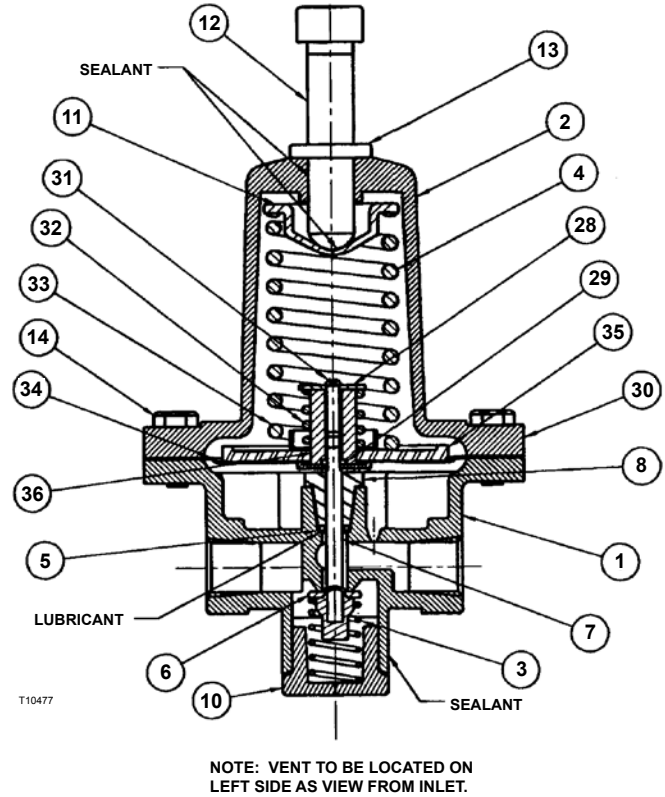

Figure 2. Type 64SR LP-Gas Regulator Assembly

1. Recommended spare part.

### LP-Gas Equipment

#### Emerson Process Management Regulator Technologies, Inc.

USA - Headquarters  
McKinney, Texas 75069-1872 USA  
Telephone: 1 (800) 558-5853  
Telephone: 1 (972) 548-3574

For further information visit [www.fisherregulators.com/lp](http://www.fisherregulators.com/lp)

The Emerson logo is a trademark and service mark of Emerson Electric Co. All other marks are the property of their prospective owners. Fisher is a mark owned by Fisher Controls, Inc., a business of Emerson Process Management.

The contents of this publication are presented for informational purposes only, and while every effort has been made to ensure their accuracy, they are not to be construed as warranties or guarantees, express or implied, regarding the products or services described herein or their use or applicability. We reserve the right to modify or improve the designs or specifications of such products at any time without notice.

Emerson Process Management does not assume responsibility for the selection, use or maintenance of any product. Responsibility for proper selection, use and maintenance of any Emerson Process Management product remains solely with the purchaser.